

# Commercial Sale

- 2051 NW 112th Ave # 115, Sweetwater, Florida 33172

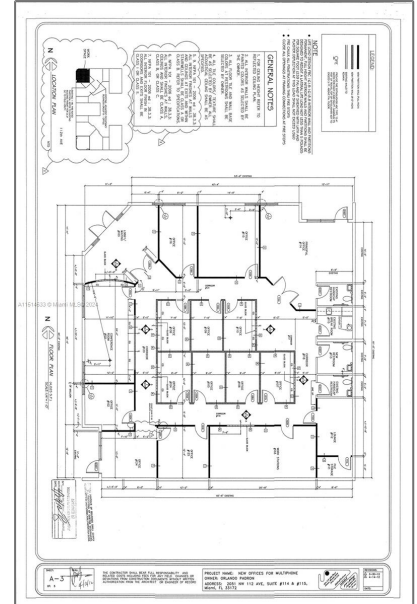

## Basic Details

Property Type: **Commercial Sale**

Property Sub Type: **Office**

Listing Type: **For Sale**

Listing ID: **A11514633**

Price: **\$10,425**

Year Built: **2006**

Built up area: **4,170 Sqft**

✓ Type of Business: **Office Space**

## Features

✓ Heating System: **Central Electric, Central Gas**

✓ Cooling System: **Central Individual A/c**

✓ Security: **Smoke Alarm, Smoke Detector(s), Fire Sprinkler System, Security Guard**

✓ Roof Deck: **Concrete**

✓ Parking: **Assigned, Guest**

✓ Flooring: **Wood, Tile**

✓ Lot Features: **Commercial Park, Corner Lot**

✓ Sewer: **Public Sanitation**

Water Front: **1**

Address [Map](#)

Country:	US
State:	FL
County:	Miami-Dade County
City:	Sweetwater
Zipcode:	33172
Street:	2051 NW 112th Ave # 115
Street Number:	2051
Building Name:	DOLPHIN PARK OF COMMERCE
Floor Number:	0
Longitude:	W81° 37' 24.8"
Latitude:	N25° 47' 34.8"
Unit Number:	114 & 115
Parcel Number:	25-30-31-041-0140
Zoning:	7100
<div>✓</div> Street pre Direction:	Nw